

Appendix 1-1

Team CVs



CURRICULUM VITAE

MICHAEL WATSON

Michael Watson is Project Director and head of the Environment Team in McCarthy Keville O'Sullivan (MKO). Michael has extensive experience as project strategy advisor & coordinator on large multi-disciplinary project teams on complex projects requiring EIS/EIAR, EPA Licence application's, hydrogeological assessments, environmental due diligence and general environmental assessment on behalf of clients in the wind farm, waste management, public sector, commercial and industrial sectors nationally. Michaels key strengths include project strategy advice, project management and liaising with the relevant local authorities, Environmental Protection Agency (EPA) and statutory consultees as well as coordinating the project teams and sub-contractors. Michael is a key member of the MKO senior management team and as head of the Environment Team has responsibilities to mentor various grades of team members, foster a positive attitude and promote continuous professional development for employees.

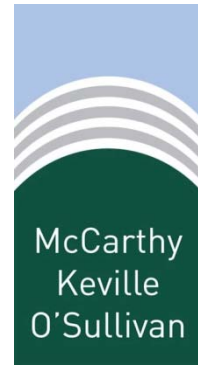

Current Role	Project Director
Qualifications	<ul style="list-style-type: none"> MA Environmental Resource Management, Geography, from National University of Ireland, Maynooth (1999). BA in Geography and Economics, NUI Maynooth (1998)
Memberships	<ul style="list-style-type: none"> Member of IEMA, a Chartered Environmentalist (CEnv) Member of IGI, a Professional Geologist (PGeo) Member of CIWM, a Chartered Waste Manger (MCIWM)
Years of Experience	<ul style="list-style-type: none"> Assistant Grade – Geological Survey Ireland – (1999-2000) Assistant - Senior Environmental Consultant – O'Callaghan Moran Environmental & Hydrogeological (2001 – 2014) Project Director – McCarthy Keville O'Sullivan – (2014-Present)
Key Strengths & Areas of Expertise	<p>Michaels key strengths include project strategy advice for a wide range and scale of projects, project management and liaising with the relevant local authorities, Environmental Protection Agency (EPA) and statutory consultees as well as coordinating the project teams and sub-contractors.</p> <p>Michael's key areas of expertise include managing Environmental Impact Assessments, EPA Licence applications, hydrogeological assessments, environmental due diligence and general environmental assessment on behalf of clients in the wind farm, waste management, public sector, commercial and industrial sectors nationally.</p>
Role in MKO & Relevant Experience	<p>Michael is a key member of the MKO senior management team and as head of the Environment Team has responsibilities to mentor various grades of team members, foster a positive attitude and promote continuous professional development for employees.</p> <p>As Project Director, Michael's responsibilities include coordinating large project teams to deliver technically robust and environmentally sound assessments for all ranges of project types and scales and providing project strategy advice to clients in both the private and public sectors.</p>
Personal Skills & Achievements	<p>In 2015, Michael was interviewed by a panel of professional geologists from the Institute of Geologists Ireland and was awarded Professional Geologist status.</p> <p>In 2017, Michael completed the application process and was interviewed by a panel from the Institute of Environmental Management & Assessment (IEMA) UK and was accepted as a Chartered Environmentalist.</p>



CURRICULUM VITAE

CIARA MCGUINNESS

Ciara McGuinness is a Planner with McCarthy Keville O'Sullivan Ltd. with over 3 years of experience in both private practice and local authorities. Ciara took up her position with McCarthy Keville O'Sullivan in October 2016. Ciara's key strengths and expertise are Project Management, Development Management and Masterplanning, Environmental Impact Assessments and Collaborative Planning.

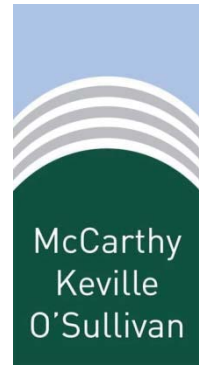

Current Role	Planner
Qualifications	<ul style="list-style-type: none"> • BA (Hons) Geography Planning and Environmental Policy, University College Dublin (2013) • MSc (Hons) Environmental Policy, University College Dublin (2014) • Distinction Diploma Project Management, Dublin Business School (2015)
Memberships	<ul style="list-style-type: none"> • Corporate Member of the Irish Planning Institute (2017)
Years of Experience	<ul style="list-style-type: none"> • McCarthy Keville O'Sullivan (October 2016- Present) • Consultant Planner, LUC, London (July 2015- September 2016) • Planning Intern, Drawing & Planning, London (May 2015- July 2015) • Student Planner, Offaly County Council (June 2011- July 2011)
Key Strengths & Areas of Expertise	<p>Project Management: Project Management of complex, multi-disciplinary planning applications.</p> <p>Development Management/Masterplanning: The preparation of planning applications and masterplans on behalf of the public and private sector client base. Preparation of detailed planning appraisals and feasibility reports.</p> <p>Renewable Energy Development: Significant experience in guiding commercial scale solar developments and wind farms through the statutory planning process.</p> <p>Environmental Impact Assessments: Production EIS/EIAR chapters for a wide range of project applications, from small developments, to large multi-million euro project applications.</p> <p>Collaborative Planning: Experienced stakeholder engagement facilitator.</p>
Role in MKO & Relevant Experience	<ul style="list-style-type: none"> • Planning Consultant on a significant range of energy infrastructure, commercial, student housing and residential projects including:- <ul style="list-style-type: none"> ○ Ardstone Homes, Knocknacarra, Galway City (mixed use scheme comprising 88 no. residential units and 760 sqm of commercial floor space). ○ Ardstone Homes, Oranmore, Co. Galway (80 no. residential units). ○ Westwood Student Accommodation, Dangan, Upper Newcastle, Galway City (425 no. bedspaces arranged in 5 no. blocks). ○ Mixed Use Development, Kylebroghlan, Moycullen, Co. Galway (Two- storey Primary Care Centre and 49 no. residential units comprising). • Project managing circa 20MW of solar energy planning applications through the statutory planning system.
Personal Skills & Achievements	<ul style="list-style-type: none"> • Extensive experience in building and maintaining strong working relationships with local authority planners, landowners and consultants. • Responsible for the creation and maintenance of a renewable energy project database used for analysis on future pipeline projects.



CURRICULUM VITAE

Eoin Gilson

Eoin is a Graduate Environmental Scientist with McCarthy O'Sullivan Ltd. who took up his position in October 2018. Eoin holds a BSc (Hons) in Microbiology and a MSc (Hons) in Applied Environmental Science. Eoin has specialist knowledge in environmental field surveys, data analysis and renewable energy systems. Eoin's key strengths and areas of expertise are in data management, report writing and environmental monitoring and management. On joining MKO Eoin has been involved on a range of renewable energy infrastructure projects, working as part of a large multi-disciplinary team to produce EIA Reports.

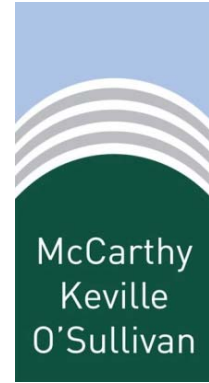

Current Role	Graduate Environmental Scientist
Qualifications	<ul style="list-style-type: none"> • MSc (Hons) Applied Environmental Science • BSc (Hons) in Microbiology
Memberships	<ul style="list-style-type: none"> • CIEEM – Graduate Membership
Years of Experience	<ul style="list-style-type: none"> • 0-1 years
Relevant Experience	<ul style="list-style-type: none"> • Working on a range of renewable energy infrastructure projects, working as part of a large multi-disciplinary team to produce EIA Reports. • Completed a master's research project to test the biogas production potential of perennial wetland grasses and a cost benefit analysis of the economic viability.
Practical Skills and Aptitudes	<ul style="list-style-type: none"> • Data management • Report writing • Environmental monitoring and management
Management/ Supervision	<ul style="list-style-type: none"> • Coordination across various teams
Interpersonal & Communication Skills	<ul style="list-style-type: none"> • Effective written and verbal communicator • Excellent ability to take direction • Ability to work on own initiative and as part of a multi-disciplinary team
Licenses Held	<ul style="list-style-type: none"> • Full Clean Driving Licence • Safe Pass
Physical / Other	<ul style="list-style-type: none"> • Physically fit and healthy

CURRICULUM VITAE

IRENE SULLIVAN

Irene is a Graduate Ecologist with McCarthy Keville O'Sullivan Ltd. Irene holds a BSc. (Hons) in Zoology. Irene has a strong background in applied ecology and conservation biology. Since joining MKO, Irene has been involved as a graduate ecologist on a significant range of habitat assessments and ecological survey work including bat surveys, bird surveys, and multi-disciplinary surveys. Within MKO, Irene has contributed to a variety of project reports while developing mapping and research skills. Irene is a member of Birdwatch Ireland, the Irish Herpetological Society and the Irish Wildlife Trust.



Current Role	Graduate Ecologist
Qualifications	BSc. (Hons.) Zoology, University College Dublin, 2016
Memberships	Birdwatch Ireland, Irish Wildlife Trust, Irish Herpetological Society
Years of Experience	<p>Graduate Ecologist, MKO July 2018 - Present. Previous working roles include:</p> <ul style="list-style-type: none"> • Research assistant with the SHINE project (UCC) (2018) • Curlew Action Team Assistant with the Curlew Conservation Programme (2018) • Tern Warden with Birdwatch Ireland's Little Tern Conservation Programme (2017) • Intern/research assistant in Bio-invasions Lab (UCD) (2015) <p>Voluntary experience includes:</p> <ul style="list-style-type: none"> • Surveyor with the Irish Hen Harrier Winter Survey (2017, 2018) • I-WeBS and Irish Garden Bird surveyor (2017) • Student Researcher with Operation Wallacea (2015)
Key Strengths & Areas of Expertise	<ul style="list-style-type: none"> • Strong ornithology background and bird identification skills which are consistently improving • Good working knowledge of all Microsoft Office applications and considerable experience of collecting, entering and collating data as part of previous working roles and undergraduate studies • Significant amount of in-field experience in applied ecology • Excellent interpersonal and communication skills
Role in MKO & Relevant Experience	<ul style="list-style-type: none"> • Carrying out bird, bat, habitat and multi-disciplinary surveys in compliance with standards of best practice • Writing and contributing to EclA, AA and EIA reports • Mapping using GIS software
Personal Skills & Achievements	<ul style="list-style-type: none"> • Irish Driver's License • 1 Star scuba diver qualification awarded by Irish Underwater Council • Crawford-Hayes Bursary, UCD • Current Safe Pass holder



CURRICULUM VITAE

KATHRYN BLADE

Kathryn Blade is a Landscape Architect with McCarthy Keville O'Sullivan Ltd. with 2 years' experience within private practice. Kathryn took up her position with McCarthy Keville O'Sullivan in July 2018. Kathryn's key strengths and expertise are Public Realm Design, Leisure and Residential Development, Landscape and Visual Impact Assessments and Landscape Masterplanning and Management.



Current Role	Landscape Architect
Qualifications	<ul style="list-style-type: none"> BSc (Hons) Landscape Architecture, University College Dublin
Memberships	<ul style="list-style-type: none"> Licentiate Member, Landscape Institute (U.K.)
Years of Experience	<ul style="list-style-type: none"> 2018 – Present. Landscape Architect, McCarthy Keville O'Sullivan Ltd. 2018 – 2018. Graduate Landscape Architect, The Paul Hogarth Company, Belfast 2017 – 2018. Graduate Landscape Architect, AECOM, Belfast 2015 – 2016. Assistant Landscape Architect, AECOM, Belfast
Key Strengths & Areas of Expertise	<ul style="list-style-type: none"> Specialist knowledge in Landscape and Visual Impact assessments for projects ranging from individual houses to large wind farms, landscape master-planning and management plans, strong computer-based expertise, drawing, design and graphics ability.
Role in MKO & Relevant Experience	<ul style="list-style-type: none"> Since joining MKO Kathryn has been involved in projects such as energy infrastructure, extraction industry and residential projects. Within MKO Kathryn works as part of a large multi-disciplinary team to produce EIA Reports.
Personal Skills & Achievements	<ul style="list-style-type: none"> Played a key role in the development of the greater Belfast area. She was part of the core team providing landscape master-planning and design services on a wide range of projects within the greater Belfast area as part of the urban villages initiative. The Urban Villages Initiative is a key action within the Northern Ireland Executive's Together: Building a United Community (TBUC) Strategy. It's designed to improve good relation outcomes and to help develop places where there has been a history of deprivation and community tension. Kathryn worked closely with all the members of the design team to create the masterplan for a mixed-use development in Bahrain. Initial phases of the masterplan have been brought from preliminary design to implementation on site. The scheme includes commercial streets, residential areas, parks, private and public beaches, play areas, hotels, shopping centre and cruise-ship terminal.



CURRICULUM VITAE

JOHN STAUNTON

Dr. John Staunton PhD. joined McCarthy Keville O'Sullivan in October 2014 following completion of a PhD in Environmental Science in NUI Galway. He has a scientific background and has a proven record in project design, field survey techniques, GIS mapping, report writing, and publishing, being lead author on four peer-reviewed publications in international scientific journals. He has over four years professional experience in environmental consultancy during which time he has completed fieldwork, data analysis literature reviews and written reports for various EIS/EIAR chapters in a wide range of projects including multi-million euro developments. He has also supervised research projects dealing with various aspects of wind energy and the environment.

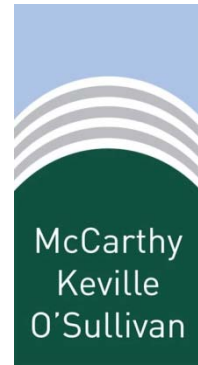

Current Role	Project Environmental Scientist
Qualifications	<ul style="list-style-type: none"> • B.Sc. (1st class hon) Environmental Science - NUI Galway. • PhD. Environmental Science - NUI Galway
Years of Experience	<ul style="list-style-type: none"> • 2014 – Present: Environmental Scientist, McCarthy Keville O'Sullivan • 2008-2014: Postgraduate Environmental Research, NUI Galway
Key Strengths & Areas of Expertise	<p>Project Management: Project manager for projects ranging from small to multi-million euro developments. This involves the management/coordination of multi-disciplinary teams to produce large reports.</p> <p>Field survey/sampling techniques: Experienced in completion of surveys and/or sampling for ecology, hydrology, soils, landscape and visual and Human Beings. Previous work has resulted in 4 international scientific publications, as well as feeding into a large number of Environmental Reports (ER) and Environmental Impact Statements / Environmental Impact Assessment Reports (EIS/EIAR) for projects of various sizes.</p> <p>Desk studies: Carrying out regular desk studies in a wide range of environmental topics, from hydrology and geology, to human health, to air & climate. These desk studies usually feed into larger reports.</p> <p>Report Writing: Writing ER, EIS/EIAR and Strategic Environmental Assessment chapters which have been used for a variety of projects, from energy infrastructure applications, to flood relief schemes and hydrological monitoring.</p> <p>GIS Mapping: Competent in the production of high quality maps using GIS mapping software. These maps have been used in various reports and in scientific publications.</p>
Role in MKO & Relevant Experience	<ul style="list-style-type: none"> • Production of ER and EIS/EIAR chapters for a wide range of project applications, from small developments, to large multi-million euro project applications. • Completing field surveys/sampling for a variety of topics/areas • Project management for a variety of project types
Personal Skills & Achievements	<ul style="list-style-type: none"> • Lead author of 4 international peer-reviewed environmental scientific research papers • Safe Pass, Remote First Aid, Full Drivers License, Water Safety, Statistical Analysis

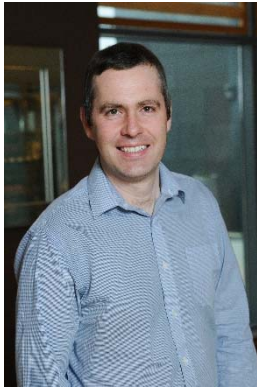

CURRICULUM VITAE

OWEN CAHILL

Owen is an Environmental Engineer with McCarthy O'Sullivan Ltd. with over 10 years of experience in the Environmental Management and Construction Industries. Owen's wide ranging multi sector experience has provided him with specialist knowledge and understanding of the challenges in the planning and delivery of developments with the minimum environmental impact and with practicality and constructability in mind. Owen has been involved as a Project Manager on a range of energy infrastructure, commercial, residential, waste facility and quarry projects as well as managing the licensing requirements of a number of EPA licensed facilities.

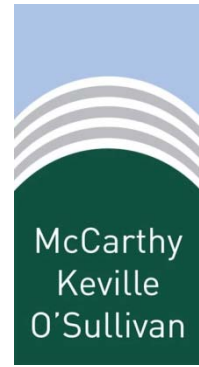

Current Role	Environmental Engineer
Qualifications	<ul style="list-style-type: none"> • Bachelor of Science (Hons) Construction Management, Galway Mayo Institute of Technology (2004) • Master of Science Construction Management, Galway Mayo Institute of Technology (2007) • Master of Science Environmental Engineering, Queens University Belfast (2010)
Memberships	<ul style="list-style-type: none"> • Affiliate Member of the Institute of Environmental Management & Assessment (2016)
Years of Experience	<ul style="list-style-type: none"> • Environmental Technician, Pentland Macdonald, Holywood, Co. Down (December 2010 – May 2011) • Environmental Health & Safety Officer, Kepak Group, Clonee, Co. Meath (June 2011- March 2012) • Environmental Engineer, McCarthy Keville O'Sullivan, (October 2013- present)
Key Strengths & Areas of Expertise	<p>Owen's key strengths include his multi sector professional experience on projects with the ability to adapt to the requirements of a project throughout the planning, construction and operational phases. and liaising with the relevant local authorities, Environmental Protection Agency (EPA) and statutory consultees as well as coordinating the project teams and sub-contractors.</p> <p>Owen's key areas of expertise are in project management, environmental impact assessment, wind energy & solar energy construction & environmental management planning and waste permit management. on behalf of clients in the wind farm, waste management, public sector, commercial and industrial sectors nationally.</p>
Role in MKO & Relevant Experience	<p>Owen plays a large role in the management and confidence building of junior members of staff and works as part of a large multi-disciplinary team to produce EIS/EIAR Reports.</p> <p>As a Project Manager, Owen's responsibilities include coordinating project teams to deliver technically robust and environmentally sound assessments for all ranges of project types in both the private and public sectors.</p>
Personal Skills & Achievements	<ul style="list-style-type: none"> • Contributed to the launch of the MKO Water Quality Monitoring Service unit with the use of in-situ continuous water quality loggers which have been successfully deployed at a number of construction projects to provide current water quality data. • Strong organisational skills, with an ability to coordinate and participate effectively as part of a larger multi-disciplinary team to achieve project goals.



CURRICULUM VITAE

ÓRLA MURPHY

Órla Murphy is an Environmental Scientist with McCarthy Keville O' Sullivan Ltd. with nearly 2 years of experience in private consultancy. Órla took up her position with McCarthy Keville O' Sullivan in January 2018. Órla's key strengths and expertise are Environmental Protection and Management, Environmental Impact Statements, Project Management, Renewable Energy and Peatland Management.

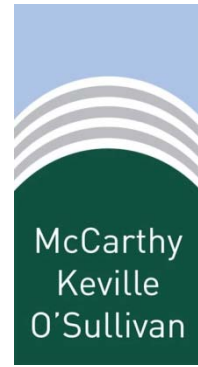

Current Role	Environmental Scientist
Qualifications	<ul style="list-style-type: none"> • MSc. (Hons) Environmental Protection and Management, University of Edinburgh. • BSc. (Hons) Geography, Queens University Belfast.
Memberships	<ul style="list-style-type: none"> • Graduate Member of IEMA
Years of Experience	<ul style="list-style-type: none"> • 2018 – Present, Environmental Scientist, McCarthy Keville O'Sullivan. • 2015 – 2017 – Environmental Project Assistant, ITP Energised, Edinburgh.
Key Strengths & Areas of Expertise	<p>Project Management: Involved in managing and assisting in a variety of wind energy and residential projects. This involved liaison with subcontractors and other team members in order to successfully deliver projects.</p> <p>Field Work and Site Visits: Carried out fieldwork in various areas, in particularly peat probing and identification of onsite conditions to aid Peat Management Plans and Peat Slide Risk Assessments. Additional survey work includes use of ISCO water pollution samplers, installation of dipwell monitors and headspace sampling regarding surface water levels and instream DOC concentrations.</p> <p>Desk studies: Carrying out desk studies in a wide range of environmental topics, including hydrology and geology, archaeology and cultural heritage and landscape and visual. These desk studies mainly feed into larger reports.</p> <p>Report Writing: Writing ER, EIA and chapters which have been used for a variety of projects, from energy infrastructure applications, to flood relief schemes and hydrological monitoring.</p> <p>GIS Mapping: Fully trained in the use of GIS for producing maps, using spatial analyst and terrain mapping for topography and slope figures used as part of various reports.</p> <p>Peatland Environments: Identification of bogland species both in Northern Ireland and Scotland, ability to measure and understand the impact of water table on bog conditions, understanding of restoration and protection methods within peatland ecosystems as well as general legislation involved in protecting these areas. I have then carried out peatland assessments, namely peat management plans, peat slide risk assessments and various technical GIS analysis on deep peat sites.</p>
Role in MKO & Relevant Experience	<ul style="list-style-type: none"> • Production of ER and EIAR chapters for a wide range of project applications, from small developments to large renewable energy applications. • Completing field surveys/sampling for a variety of topics/areas • Project management for a variety of project types
Personal Skills & Achievements	<ul style="list-style-type: none"> • Co-author of data published in regard to instream DOC concentrations within a restored peatland site in Scotland. • Trained in Level 1 and Level 2 Flood Risk Assessment.



CURRICULUM VITAE

PAT ROBERTS

Pat Roberts is a Senior Ecologist and director of the Ecology team with McCarthy O'Sullivan Ltd. with over 12 years' experience. Pats key strengths include his depth of knowledge and experience of a wide range of ecological and biodiversity topics. He currently manages the ecological team within MKO and ensures that the outputs from that team are of a very high standard and meet the requirements of the clients.

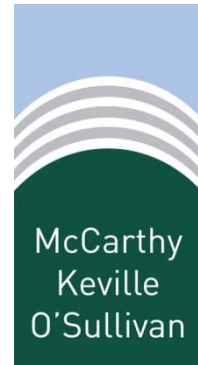

Current Role	Senior Ecologist/Director of Ecology
Qualifications	<ul style="list-style-type: none"> BTEC N. Dip (Countryside Management) (1995) B.Sc. (Environmental Science) (2005) National University of Ireland, Galway
Memberships	<ul style="list-style-type: none"> Member of Chartered Institute of Ecology and Environmental Management (CIEEM)
Years of Experience	<ul style="list-style-type: none"> 12 years post graduate experience working as a professional ecologist Over 10 years previous experience working as a nature conservation warden, tree surgeon/surveyor
Key Strengths & Areas of Expertise	<ul style="list-style-type: none"> In depth knowledge and experience in ecological surveying for a wide range of habitats and species including Habitats, Bats, Mammals, Marsh Fritillary, Freshwater Pearl Mussel, Invasive Species, Aquatic Macro-invertebrates Over 12 years post graduate experience of providing ecological services in relation to a wide range of developments at the planning, construction and monitoring stages Excellent understanding of the Appropriate Assessment process and the requirements thereof in relation to plans and projects. Level of knowledge and experience to provide advice and services tailored to the requirements of the client
Role in MKO & Relevant Experience	<ul style="list-style-type: none"> Director of the Ecology team at MKO with responsibility for ensuring that the outputs from that team are of a very high standard and meet the requirements of the clients and relevant legislation and guidelines. Overseeing ecological assessments, Appropriate Assessment services and input into EIARs for numerous large scale developments including windfarms, flood relief schemes road projects, amenity, leisure and commercial projects Overseeing invasive species surveying, treatment and management Overseeing Ecological Clerk of Work services provided by the company for a variety of clients including Local Authorities, Private Contractors and Irish Water
Personal Skills & Achievements	<ul style="list-style-type: none"> Twelve years ecological experience with eight years project management experience Proficient in use of MS Office programs, GIS Mapping Software, AutoCAD Certificate in Mammal Identification (Mammal Society) Freshwater Invertebrate Sampling (Field Studies Council) Bat Detector Workshop (Bat Conservation Ireland) Bats & Arboriculture Training Course, (BCT & Arboricultural Association) Assessing Forest Structure for Restoration Management Plans (CIEEM) Fresh Water Pearl Phase 1 & Phase 2 Surveying (Evelyn Moorkens)



CURRICULUM VITAE

PAMELA HARTY

Pamela Harty is a Project Planner with McCarthy Keville O'Sullivan Ltd. with over 10 years of experience in both private practice and local authorities. Pamela took up her position with McCarthy Keville O'Sullivan in September 2015. Pamela's key strengths and expertise are Project Management, Development Management and Masterplanning, Socio-Economic Impact Assessments and Collaborative Planning.

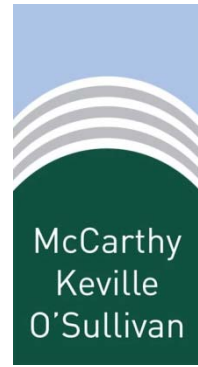

Current Role	Project Planner
Qualifications	<ul style="list-style-type: none"> • Bachelor of Arts (Hons) Geography & Legal Science, NUIG (2006) • Masters in Regional & Urban Planning, UCD (2008)
Memberships	<ul style="list-style-type: none"> • Corporate Member of the Irish Planning Institute (2012) • Chartered Member of the Royal Town Planning Institute (2012)
Years of Experience	<ul style="list-style-type: none"> • 2015 – Present Project Planner, McCarthy Keville O'Sullivan, • 2012 – 2015 Senior Planner, SLR Consulting Ltd., Belfast • 2010 – 2012 Planning Officer, The Moray Council, Morayshire, UK • 2009 – 2009 Planning Assistant, The Heritage Council
Key Strengths & Areas of Expertise	<p>Project Management: Project Management of complex, multi-disciplinary planning applications and Environmental Impact Statements (EIS's)</p> <p>Development Management/Masterplanning: The preparation of planning applications and masterplans on behalf of the public and private sector client base. Preparation of detailed planning appraisals and feasibility reports.</p> <p>Socio-Economic Impact Assessments: Significant experience in preparing S-EIAs for energy infrastructure and mixed-use development projects (including a Nationally Significant Infrastructure Project on behalf of National Grid in the UK)</p> <p>Collaborative Planning: Experienced community engagement facilitator.</p>
Role in MKO & Relevant Experience	<ul style="list-style-type: none"> • Project Planning Consultant on a significant range of energy infrastructure, commercial, student housing and residential projects including:- <ul style="list-style-type: none"> ○ IVS Student Housing Development Bohermore, Galway City ○ Luxor Investments, Dublin 8 (comprising a convention centre, 86 no. apartments and hotel extension) ○ Ardstone Homes, Knocknacarra, Galway City (mixed use scheme comprising 88 no. residential units and 760 sqm of commercial floor space). ○ NAMA Mixed Use Scheme, Ballyburke, Galway City (172 no. apartments and commercial crèche). ○ Ardstone Homes, Oranmore, Co. Galway (80 no. residential units). • Project managing circa 35MW of solar energy planning applications through the statutory planning system, with a further 40MW in the pipeline at pre-planning stage
Personal Skills & Achievements	<ul style="list-style-type: none"> • Played a key role in development of the Paisley Town Centre Heritage Assets Strategy which was awarded the International Innovation Award at the IPI Awards 2015/2016; UK Placemaking Awards; 'Scottish Awards for Quality in Planning 2015'; RTPI Planning Excellence Awards 2014; Haymarket Planning Awards 2014. • Played a key role in the development of the Lakes at Rhosaman Masterplan, which was awarded the International Innovation Award at the IPI Awards 2015/2016

CV for Patrick McCaul – Project Director, Lead Building Services Engineer & Chartered Engineer.

Name	Role on These Projects	Academic Qualifications
Patrick McCaul	Project Director & Energy Consultant within Multi-Disciplinary Teams	B.Eng (Hons) Environmental Engineering 1989
		Chartered Engineer - C. Eng. M.C.I.B.S.E. 1993 FConsEI
Experience	Construction	28 Years
	This Firm	26 Years
Client	Date	Description of Exact Role
Dalata Hotel Group	Start 2017 Completed 2018	Clayton Hotel Ballsbridge, Dublin for Dalata Hotel Group Contract Value: €8,000,000 Completion August 2018 Complete M&E Design Responsibility for a 50 Bedroom Roof-top extension to existing Landmark hotel in Ballsbridge and additionally included ground floor and lower ground floor refurbishment within a live hotel environment (Bar, Dining, Coffee Dock and Reception areas).
JJ Rhatigans	Start 2017 Completed 2018	Maldron Hotel, Kevin Street, Dublin for JJ Rhatigans Contract Value €16,000,000 Completion July 2018 Full M&E Design Services for a 139-bed new build Maldron Hotel in a Dublin City Centre Location. The project was completed as part of a design and build process for Dalata Hotel Group.
Sligo Institute of Technology	Start 2014 Completed 2017	School of Business & Social Sciences (€7M) Project Director on a 4,400 square metre refurbishment comprising 16 classrooms/lecture theatres; eight PC labs; four Early Childhood/Creative Design Studios; two social learning areas; offices for 72 staff as well as a café and support space.
BOM, Scoil Phadraig, Westport	Start 2012 Completed 2017	Scoil Phadraig National School, Westport, Co Mayo (€3M) – Project Director for the design and construction of a new primary school in Westport Co Mayo. The school consisted of a 16 classroom school with a tailored General purpose hall & landscaping to suit the needs of a town centre integrated school. The mechanical and electrical installation was tailored to meet the out of hours use of the school whilst maintaining functionality for use by youth without sacrificing security or safety and for ease of use by all ages and special needs.
Donegal Education & Training Board	Start 2013 Completed 2017	Deele College - Stand Alone Extension and Refurbishment of Existing College Building (€3.5M) Design Lead for the M&E Services for the design and construction of a stand-alone extension (1,900m ²) and the refurbishment of the existing College building at Deele College, Raphoe, Co Donegal providing the local area with a state of the art educational establishment. The works on this project incorporated a whole school approach with the upgrade of existing classrooms to latest TGD's and learning requirements.

JJ Rhatigan & Co	2015	Project Director on the completed 3 No .Primary Care Centres (€25M) to Bid stage for Balfour Beatty / JJ Rhatigan & Company, who won the bid. This bid was intense and as part of the bid we had to complete a full design of all Mechanical and Electrical services for the Primary Care Centres to the HSE's detailed brief. The 3 Centres were; Kilcock - Co.Kildare, Boyle - Co.Roscommon & Ballymote - Co.Sligo.
Westport Town Council	Start 2014 Completed 2015	Westport Townhall and Theatre (€3M) Design Lead for the M&E Services for the refurbishment of Westport Town hall. The refurbishment provided a modern performing arts centre incorporating a 244-seat theatre and general-purpose hall for local and travelling performances, and a community meeting room overlooking the Octagon, all with associated facilities.
Health Service Executive	Start 2011 Completed 2014	Med Education & Training Facilities at Sligo & Letterkenny University Hospitals for HSE and NUIG (€7m) Project Director - The design of specialist engineering services including heat recovery, ventilation, heating, electrical distribution, lighting power, emergency lighting, lightning protection, BMS, fire alarm system, lifts, medical gases, call systems, security access, CCTV, water services and public health. This project was undertaken in live Acute Hospital environments.
Apex Housing Association	Start 2011 Completed 2014	Housing Development at Circular Road, Creggan, Derry for Apex Housing Association (€20M) – Project lead for the complete design and overseeing of the M&E installation on behalf of Apex Housing, for 180 No House units (5 No House Types varying from 2, 3, 5 and bedrooms).
Harcourt Developments Ltd.	Start 2013 Completed 2014	Stanley Dock Hotel, Liverpool (€21M) Project Partner on the design of complete mechanical and electrical services for this major Refurbishment of a 180 bedroom Hotel design and build project.
South Dublin Council	Start 2009 Completed 2013	Valhalla Housing Development (Sheltered/Social Housing) (€3.5M) M&E Project Lead for the design for South Dublin City Council (12 No units) whereby the scheme achieved A1/A2 ratings under the BER scheme with the inclusion of renewable technologies, Ventilation Heat Recovery System, Improved Airtightness and Higher Level of Thermal Insulation. Valhalla has won the Irish Council for Social Housing (ICSH) award for: Housing for people with disabilities and the ICSH overall award for Housing 2015.
Harcourts Ltd.	Start 2007 Completed 2011	Portlaoise Shopping Centre (€50M) Lead M&E Engineer and energy assessor on large shopping centre with car parking, in Co. Laois, 2 (30,000m ²)
Health and Safety		
Safe-Pass/ CSR (2 days)	CEF	Renewed March 2017
CDM ; 2015 – CDM Designer / Risk Assesment	Consensa H&S Training	April 2017
Construction (CDM) Regs 2015 for GB/NI	Consensa H&S Training	March 2015
SHWW Regs 2013 ROI	Consensa H&S Training	March 2015

CV for Niall O'Kane – Design Manager, Lead Design Engineer & Chartered Engineer

Name	Role on These Projects	Academic Qualifications
Niall O'Kane	Design Lead Building Services Engineer within Multi-Disciplinary Teams and Safety & Health Officer	B.Eng (Hons) Environmental Engineering 1990
		Chartered Engineer - C. Eng. M.C.I.B.S.E. 2014
		BREEAM (Educational) Assessor - 2012
		Code for Sustainable Homes Assessor - 2012
Experience	Construction	28 Years
	This Firm	26 Years
Client	Date	Description of Exact Role
Dalata Hotel Group	Start 2017 Completed 2018	Clayton Hotel Ballsbridge, Dublin for Dalata Hotel Group Contract Value: €8,000,000 Completion August 2018 Complete M&E Design Manager for a 50 Bedroom Roof-top extension to existing Landmark hotel in Ballsbridge and additionally included ground floor and lower ground floor refurbishment within a live hotel environment (Bar, Dining, Coffee Dock and Reception areas).
JJ Rhatigans	Start 2017 Completed 2018	Maldron Hotel, Kevin Street, Dublin for JJ Rhatigans Contract Value €16,000,000 Completion July 2018 Full M&E Design Manager for a 139-bed new build Maldron Hotel in a Dublin City Centre Location. The project was completed as part of a design and build process for Dalata Hotel Group.
Sligo Institute of Technology	Start 2014 Completed 2017	School of Business & Social Sciences (€7M) Design Manager on a 4,400 square metre refurbishment comprising 16 classrooms/lecture theatres; eight PC labs; four Early Childhood/Creative Design Studios; two social learning areas; offices for 72 staff as well as a café and support space.
BOM, Scoil Phadraig, Westport	Start 2012 Completed 2017	Scoil Phadraig National School, Westport, Co Mayo (€3M) – Design Manager for the design and construction of a new primary school in Westport Co Mayo. The school consisted of a 16 classroom school with a tailored General purpose hall & landscaping to suit the needs of a town centre integrated school. The mechanical and electrical installation was tailored to meet the out of hours use of the school whilst maintaining functionality for use by youth without sacrificing security or safety and for ease of use by all ages and special needs.
Apex Housing Association	Start 2011 Completed 2014	Housing Scheme at Circular Road, Creggan, Derry for Apex Housing Association (€20M) – Design lead for the complete design and overseeing of the M&E installation on behalf of Apex Housing, for 180 No House units (5 No House Types varying from 2, 3, 5 and bedrooms). Given the format of the NEC contract there is a high emphasis to equipment specification and M&E services details. Within each house type the

		equipment performance specification was detailed to outline the product quality required for the scheme, with the system design drawings and schematics highly detailed to avoid confusion and misrepresentation.
South Dublin Council	Start 2009 Completed 2013	Valhalla Housing Development (Sheltered/Social Housing) M&E Design Lead for the design for South Dublin City Council (12No units) whereby the scheme achieved A1/A2 ratings under the BER scheme with the inclusion of Air Source Heat Pumps, Solar Water Heating, Photo Voltatics, Ventilation Heat Recovery System, Improved Airtightness and Higher Level of Thermal Insulation. Valhalla has won the Irish Council for Social Housing (ICSH) award for: Housing for people with disabilities and the ICSH overall award for Housing 2015.
Harcourt Developments Ltd.	Start 2013 Completed 2014	Stanley Dock Hotel, Liverpool (€21M) Design Lead on the design of complete mechanical and electrical services for this major Refurbishment of an 180 bedroom Hotel design and build project. Attended design team and client meetings.
Apex Housing Association	Start 2009 Completed 2010	Calgagh - Apex HQ, (€3M) Lead Engineer on hi tech, low carbon design/sustainable offices. Refurbishment and change of use project in a busy city centre location.
Dept. of Education (NI) (DENI)	Start 2006 Completed 2010	Lisburn College (€26M) Design Lead. Design and construction of new hi tech sustainable College of Higher Education in Lisburn – (17835m ²) – PFI Project
Mayo County Council	Start 2006 Completed 2009	Saleen Housing Association (Social Housing) €9M Phase 1 - We were appointed for the complete M&E design, co-ordination of statutory utilities and the provision of renewable energy consultancy in a client led multi-disciplinary design team for the provision of 92 No. new dwellings ranging from 2, 3 and 4 bedroom units.
DoES	On-going	M&E Design Design Lead on St Oliver Plunkett's Malihide, Scoil Phadraig, Westport, Co. Mayo, Marymount National School, Drogheda, Scoil Colmcille, Letterkenny, Scoil Iosagain, Bunrana and Scoil Mhuire in Stranorlar.
JJ Rhatigans	Start 2006 Completed 2008	Golden Lane Development, Dublin (€30 – 50M) Design Lead on large scale mixed development including Radisson Hotel, completed 2008 Dublin (16800m ²) Currently working on an extension to this Hotel for 100 beds, 1,000 seater Conference Centre and Leisure area.
Health and Safety		
Safe-Pass/ CSR (2 days)	CEF	Renewed March 2017
CDM ; 2015 – CDM Designer / Risk Assesment	Consensa H&S Training	April 2017
Construction (CDM) Regs 2015 for GB/NI	Consensa H&S Training	March 2015
SHWW Regs 2013 ROI	Consensa H&S Training	March 2015

Frank Coyne

ÆGIS ARCHAEOLOGY LTD

Mobile: 086 8293220

Email: frank@aegisarc.com

Address: 32 Nicholas St, King's Island, Limerick,
V94V6F7



Qualifications

- Higher Diploma in Education (H. Dip. in Ed.)
Subject: Education
Awarding Body: NUI, University College Galway
Dates: 1990-1991
- Bachelor of Arts Degree (BA)
Subjects: Archaeology and History
Awarding body: NUI, University College Galway
Dates: 1986-1989

Work Experience

Frank is a practicing professional archaeologist with 27 years of archaeological experience, 21 years at Aegis, established in 1997. He has considerable experience in:

- Archaeological Impact Assessments, as stand-alone studies and as part of larger EIS, SEA, and constraints studies;
- Archaeological test trenching;
- Archaeological Excavation;
- Archaeological Monitoring;
- Liaising with regulatory authorities, archaeologists, planners, architects, engineers, designers and site management;
- Liaising with clients and providing expert advice on all aspects of archaeology and cultural heritage;
- Issuing detailed reports for planning applications and reports to regulatory bodies to fulfil planning conditions;
- Expert witness experience (archaeology and cultural heritage).

Key Select Projects

- [Excavation at Quay St/Quay Lane, Galway \(2017-2018\)](#)

Urban excavation of a medieval building and underlying deposits in advance of development. Design team archaeologist

Client Contact: Jeremy Walsh Project Management

- [Sheen Falls Hotel, Kenmare Kerry \(2017\)](#)

Archaeological Impact Assessment in advance of renovation and extension

Client Contact: Mark Dignam, Meitheal Design Partners

- [Archaeological Survey Westmeath \(2017\)](#)

Review and compilation of 1,000 descriptions for recorded monuments in Co. Westmeath

Client Contact: Caimhin O'Brien, Archaeological Survey of Ireland, National Monuments Service, DCHG

- [Moneypoint Clare to Old Street Galway EIS](#)

Deskbased cultural heritage section & review of access

Client Contact: Donna Hassett (Mott MacDonald) for Eirgrid

- [Landscape Character Assessment for Urban Stretches of Grand and Royal Canals \(2016\)](#)

Historic Landscape Characterisation component & team archaeologist

Client Contact: Ruth Minogue Project Manager, RMA for Waterways Ireland

This project nominated for Europa Nostra Awards.

- [Landscape Character Assessment for South Dublin administrative Area \(2015-2016\)](#)

Historic Landscape Characterisation component & team archaeologist

Client Contact: Ruth Minogue Project Manager, RMA for South Dublin County Council

- [Archaeology Strategy Document for Urban Centre \(2013-2014\)](#)

Development and Archaeology Strategy for King's Island Limerick. Team lead Aegis Archaeology

Client Contact: Seamus Hanrahan Project Manager, Limerick City and County Council

- [EIS Tarbert Power Station, Co Kerry](#)

Cultural Heritage Section and ABP Oral Hearing attendance.

Client Contact: Donna Hassett (Mott MacDonald)

- [EIS Great Island Power Station Wexford](#)

Cultural Heritage Section EIS and ABP Oral Hearing attendance.

Client Contact: Donna Hassett (Mott MacDonald)

- [EIS Barretspark, Athenry, Co. Galway](#)

Cultural Heritage Section of EIS for Power Station

Client Contact: Mark McCarthy (Mott MacDonald)

- [Ballygerry to Oilgate N25-N11 Road constraints and route selection report](#)

Cultural Heritage Section

Client Contact: Dr Ronan Hallissey (Mott MacDonald) for NRA (now TII)

- **Knocknarea Conservation Study**

Archaeological Conservation Study including assessment and statement of significance, of the Passage Tomb Tradition Monuments on the Cúil Irra Peninsula Co. Sligo, project archaeologist

Client Contact: Eamon Cody, Senior Archaeologist, NMS. National Monuments Section client.

Professional Development & Publications

Frank is a licence eligible archaeologist and has held in excess of 100 archaeological licences (please see www.excavations.ie).

Frank regularly partakes in outreach activities giving talks and leading fieldtrips to local societies. He contributes a monthly column on archaeology to the *South Kerry Advertiser*. Frank has in excess of 30 archaeological publications. A list is available upon request.

Professional Affiliations

- Member and former work group member of the Institute of Archaeologists of Ireland (IAI).
- Member and committee member of the Irish Post Medieval Archaeology Group (IPMAG)
- Since 2002, Aegis Archaeology Ltd maintains an independently certified Quality Management System IS.EN.ISO 9001:2015, EQA (Ireland Ltd).

References

Dr Michael Connolly

Kerry County Archaeologist, Kerry County Council
066-7183785

Dr Stefan Bergh

Senior Lecturer, Archaeology Department, NUIG
091-492052

Mr David Daly

Director, EQA Ireland Limited
01- 4734188

Key skills:

- Practised noise consultant & project manager
- Excellent technical knowledge & reporting proficiency
- Experienced at court and oral hearings
- Adept at managing difficult situations/conflicts
- Engaged with continuing professional development

Qualifications & memberships:

- BSc (Honours) 1993 (University College Cork)
- Diploma in Acoustics & Noise Control 2009 (Institute of Acoustics)
- MSc (Distinction) in Applied Acoustics 2015 (University of Derby)
- Certificate of competence in workplace noise risk assessment (Institute of Acoustics)
- Member of Institute of Acoustics (MIOA) & secretary of Irish IOA branch
- Member of Irish professional acoustic consultants association (ACASITI)
- Member of Engineers Ireland (MIEI)

Career history:

- 2015-present: Principal Acoustic Consultant with Damian Brosnan Acoustics, focussing on environmental and occupational noise. Sample projects are listed over.
- 2001-2014: Partner with DixonBrosnan Environmental Consultants. Role initially included preparation of environmental impact statements. Concentration on noise projects after 2005.
- 1996-2001: Environment Officer with Cork County Council Environment Department. Responsibilities included management of all Council's noise issues, assessment of planning applications & environmental impact statements, and presentation of evidence in court.
- 1993-1996: Technician with Cork County Council Environment Department. Responsibilities included water quality assessment, pollution investigation and environmental inspections.

Noise projects undertaken previously by Damian Brosnan

- Assessment of noise emissions from industrial facilities, waste management facilities, quarries, smaller commercial operations, traffic, wind farms, karting and quad bike courses, sawmills, grain drying facilities, slaughtering facilities, infrastructure projects, water supply and wastewater treatment schemes, large scale residential and retail projects, amplified music (and buskers), sports facilities, hydroelectric schemes, solar farms, shipping terminals, marine vessels, telecommunication masts, shooting ranges, etc.
- Compliance noise surveys, audits and management plans for EPA licenced facilities.
- Planning stage noise assessments, further information stage assessments, and post-planning noise compliance surveys.
- Occupational noise surveys at a wide range of facilities, large and small, including local authority premises.
- Nuisance investigations, on behalf of complainants and local authorities, and also on behalf of alleged emitters.
- Construction phase noise and vibration monitoring.
- Surveys to test equipment compliance with specifications.
- Presentation of noise training courses to site employees and local authority officers.
- Preparation of submissions to An Bord Pleanála and attendance at oral hearings.
- Attendance at court hearings and presentation of evidence.

PAT KIRWAN
ASSOCIATE
ROLE: BIM MANAGER

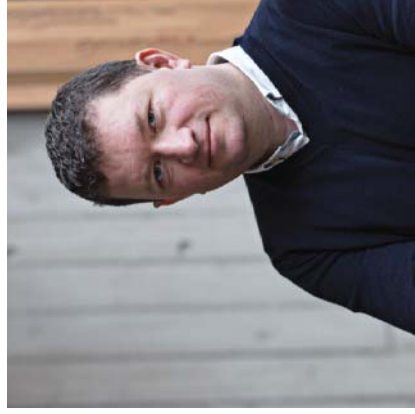

PROFESSIONAL PROFILE

Pat joined Henry J Lyons having worked previously with a number of high profile architectural practices in Ireland.

He has extensive experience working in the, commercial, retail and leisure sectors and brings an extensive knowledge of low carbon and sustainable design strategies supported with a working practice of the BREEAM and LEED environmental assessment methodologies.

Qualifications:

Dip. Arch. Tech.
 BREEAM Accredited Professional
 BREEAM International Assessor
 Passive House Certified Designer
 Revit Certified Professional

Education:

Diploma in Architectural Technology
 School of Architecture, Waterford Institute of Technology.

Registration:

RIAI
 Technician Member

Irish Green Building Council
 Lead Of Products And Materials Innovation Workgroup
 Member Of The Building Environmental Assessment Tools Workgroup.

MASTERPLANNING PROJECTS

Cardiff Lane & Lime Street Commercial
 Master planning and design of two commercial buildings totaling 300 000sqft and 120 residential apartments in the docklands precinct of Dublin. The project integrates a protected heritage structure into the design as well as enhances the existing public domain.

OFFICE PROJECTS

Central Bank of Ireland HQ, Dublin 1
 A 30,000 sqm 8 storey headquarters building over 2 storeys of basement in Dublin Docklands. It is designed to a tenant specific brief and to meet BER A3 standards as well as to achieve BREEAM Excellent accreditation.

No 3, Spencer Dock, Dublin 1*

11,000m² Six Storey, Commercial Office Block located in the heart of Spencer Dock's business district.

Apple Headquarters , Cork*

12,000m² Four Storey, BREEAM rated Commercial Office Block accommodating Apple's European, Middle East and African operations.

BAM Contractors, Little Island, Cork*

Office Accommodation for BAM Contractors at Little Island, Cork. Delivered in two phases.

COMMERCIAL FITOUT

Pfizer Global Financial Solutions, Ringsend, Dublin 4*
 Fitout of Pfizer's Global Financial Solutions Headquarters in Dublin 4.

Mercer Financial Services, Cork*

Renovation and Fitout of Mercer's Cork Operations.

SPORT AND EVENT MANAGEMENT PROJECTS

Aviva Stadium, Dublin 4*
 Multipurpose stadium incorporating a 50,000 seating capacity, corporate and banqueting facilities, state of the art players welfare and changing facilities. The Aviva stadium won Irish Green Building of the Year and World Architectural award for Accessible Design in 2011.

Sporting Campus, King Saud University, Riyadh, Saudi Arabia*

Sports Campus accommodating a 5,000 seated indoor athletics arena, Olympic sized swimming pool, 25m swimming pool and multipurpose sports hall accommodating Olympic standard gymnastic and ball sports facilities.

Paic Uí Chaoimh GAA Stadium, Cork*

Redevelopment of Paic Uí Chaoimh GAA Stadium to include provision of new two tier spectator stand accommodating player welfare & changing, corporate and event facilities.

HOTEL / LEISURE PROJECTS

Quality Hotel and Leisure Centre, Youghal, Co. Cork*
 125 Bedroom Hotel and Leisure Centre located in the coastal town of Youghal.

Cobh Marina, Cobh, Co. Cork*

200 Berth Marina, mixed use commercial and residential development on a reclaimed off shore site.

CONSERVATION PROJECTS

St Paul's Church, Glenageary, Co. Dublin*
 Conservation and restoration of a 19th Century protected structure. Conservation works included fully restoring stained glass windows and stone tracery, roof remedial and replacement works, new electric and mechanical systems and interior fitout.

COMMERCIAL / INDUSTRIAL PROJECTS

Multi Franchise Motor Show Room, Mahon Point, Mahon, Cork*
 Multi franchise motorshow rooms and workshop for Johnson & Perrott, Cork

Motor Show Room, Carlow*

Dooley Motors, Ford Showroom and workshop, Carlow.

EDUCATIONAL/INSTITUTIONAL PROJECTS

College of Sports Science and Physical Activity, King Saud University, Riyadh, Saudi Arabia*
 University Campus academic building accommodating teaching and research facilities.

Blackwater Community School, Lismore, Co. Waterford*

Educational establishment accommodating the amalgamation of three schools. Educational facilities include an Olympic standard sports hall and all weather outdoor sports facilities.

Scoil Eanna, Cope Foundation, Cork*

Additional educational facilities for Scoil Eanna, a Co-educational school for pupils with mild general learning difficulties of primary school age.



Cardiff Lane & Lime Street



Central Bank of Ireland



Apple Headquarters Cork



Aviva Stadium



Quality Hotel and Leisure Centre
 Cork

MARTIN DONNELLY
DIRECTOR
ROLE: PROJECT DIRECTOR



PROFESSIONAL PROFILE

Martin has been with Henry J Lyons Architects for over 20 years having graduated from UCD in 1982 with First Class Honours. Martin worked with Scott Tallon Walker and de Blacam & Meagher Architects before joining Henry J. Lyons Architects in 1989 and has been a Director of the practice since 1996.

He has extensive experience in the design, delivery and service management of commercial office, retail and particularly leisure and hotel buildings as well as educational, residential, leisure, master planning and urban design projects. Martin provides client consultancy specializing in procurement and due-diligence appraisal for acquisitions as well as expert witness service in the construction industry.

Qualifications:
 B. Arch(NUI), FRIAI, RIBA

Education:
 Bachelor of Architecture
 UCD/NUI 1982

Certificate in Professional Practice
 UCD/NUI 1986

Conservation Architect Grade 3
 RIAI 2009

Accredited Project Supervisor
 RIAI Design Process 2009

Registrations:
 F RIAI
 Member of the Royal Institute of Architects in Ireland

RIBA
 Member of Royal Institute of British Architects

Registered Architect
 Under the Building Control

WORKPLACE PROJECTS

Dawson St - Nassau St Retail & Office Development, Dublin 2
 Integrated 22,000m² retail and office development on prime city centre site.

Amgen Pharmaceuticals, Dun Laoghaire
 Alterations and refurbishment of 8,000m² existing pharmaceutical building. Office, Laboratory and Personnel Support Facility.

Exchange Building, Mayor Street, Dublin Docklands.
 Client (purchaser) technical advisor for development from tender-completion in 2017.

Bank of Ireland, Baggot Plaza Building, Dublin
 Due-diligence and fit-out of 16,000m² office building, 2015

1 Spencer Dock, Dublin Docklands
 Multi disciplinary due-diligence assessment for purchaser of 20,000m² existing office building, 2016.

Block R, Spencer Dock, Dublin Docklands
 Multi disciplinary due-diligence assessment for purchaser of 20,000m² existing office building, 2015

Ryanair Headquarters Building, Swords, Co. Dublin
 Due-diligence, alteration, extension and fit-out of 9,000m² office building, 2013

New Office Building, 86-88North Wall Quay, Dublin
 New 7,500m² office building permitted under DDDA SDZ planning process, 2013

Irish Turf Club, HQ, Curragh Co. Kildare
 New 3,000m² office building on Curragh

Irish League of Credit Unions HQ, Mount St, Dublin
 Alterations, extension and refurbishment of existing 4,000m² office building.

Ryanair Engineering and Training Building, Dublin Airport

Irish Pensions Board HQ, Mount St, Dublin
 Alterations and fit out (2,500m²) of office building.

Office Development, Harmony Row, Dublin
 New build (2,500m²) office building

New Street, Dublin
 New build office building

Millennium Park, Naas, Co. Kildare
 Office campus master plan and completion of 2x3,000m² new build office buildings.

Osbertown, Naas, Co. Kildare
 Own Door Office Building 2,000m²

Leinster Mills, Osbertown, Naas, Co. Kildare
 Alteration and restoration of existing mill building as office development.

HOSPITALITY PROJECTS

Maldron Hotel, New Street, Dublin
 New Hotel development of 137 bedroom hotel on city centre site.
 Ongoing, 5,700 sq. m

Holiday Inn Express, Sheffield
 New Hotel part of Crowne Plaza / Express development of 360 bedroom hotel on city centre site.
 2010-2015, 4,000 sq. m

Alterations, Extension to Connacht Hotel, Dublin Road, Galway
 88 hotel suite extension to the existing hotel (complete), 2004, 9,250 sq. m Development of public areas and an additional 80 bedrooms.
 2007-7,250 sq. m

Mariott Hotel, Heuston South Quarter, Dublin
 240 hotel bedroom and suite development incorporating conference and leisure

Great Southern Hotel, Parknaasilla, Co. Kerry
 Hotel Resort including Spa and residential housing.

Charlton Hotel, Liffey Valley, Dublin
 250 hotel bedroom and suite development incorporating conference and leisure

Mariott Druids Glen, Hotel and Golf Resort
 150 bedroom hotel incorporating conference, leisure and spa.

Hotel and Retail Development, Letterkenny
 58 Bedroom and 26 suite Hotel, public house, retail units and multi-storey car-park.
 10,000m².

Castletroy Park Hotel, Limerick
 150 bedroom hotel incorporating conference, leisure and spa.

Burlington Hotel, Dublin
 80 Bedroom Extension over three levels built at fourth floor.

Montrose Hotel, Dublin
 200 bedroom refurbishment and extension.

Glenview Hotel, Wicklow
 Public Area extension and Leisure Centre

Club Mediteranee, Waterville, Co. Kerry
 Hotel and Leisure Development, Co. Kerry

RESIDENTIAL PROJECTS

Northbank, Dublin Docklands
 Alterations to and remediation of 150 apartments. Complete 2017.

Drury Court Hotel, Dublin, Ireland
 110 Bedroom Urban Conference and Business hotel in central Dublin.

Penthouse Suite, Berkeley Court Hotel, Ballsbridge, Dublin
 750 m² Penthouse Suite in the than premier 5-star Dublin hotel to create the most opulent hospitality suite in Ireland



Dawson Street - Nassau Street Office



Bank of Ireland Baggot Plaza



Ryanair HQ



Maldron Hotel Kevin Street



Parknaasilla Co Kerry



Charlemont Street



Amgen Pharmaceuticals

EOIN DINEEN
ASSOCIATE DIRECTOR
ROLE: DESIGN IMPLEMENTATION LEAD



PROFESSIONAL PROFILE

Eoin joined Henry J Lyons in 1998, was appointed as an Associate in 2003 and has completed a wide range of projects in terms of type and scale ranging from small office fitout to large commercial mixed development in this time. Eoin has extensive experience in the construction of multiple repetitive modular buildings such as hotels and other structures where services are integrated into modular precast concrete and in both employer and contractor designed construction contracts. Eoin also has a particular interest in accessibility and has completed the RIAI Part M and Disability Access CPD. Eoin has recently become an associate director in 2017.

Qualifications:

B. Arch. FRIAI, RIBA

Education:

Bachelor of Architecture
 UCD/NUJ/1982

Certificate in Professional Practice

UCD/NUJ/1986

Conservation Architect Grade 3

RIAI/2009

Accredited Project Supervisor

RIAI Design Process 2009

Registration:

FRIAI
 Member of the Royal Institute of Architects in Ireland

RIBA

Member of Royal Institute of British Architects

Registered Architect

Under the Building Control Act 2007 (No. 87042)

OFFICE PROJECTS

Project Kells Retail & Office Development, Dublin 2

The design of high-end retail trading over three floors and 3 levels of high specification office on a prime city centre as part of a mixed-use development.
 Ongoing 7,500m²

Amgen Pharmaceuticals, Dun Laoghaire

Refurbishment of existing pharmaceutical production building to office and laboratories.
 Ongoing

Bank of Ireland, Baginbun Plaza Building, Dublin

Due-diligence and fit-out of 16,000m² office building. 2015

Buildings D9 & D10, Millennium Park, Naas, Co. Kildare

Two new three-storey office buildings
 2002 - 5,700 sq. m

Ardee Credit Union, Ardee, Co. Louth

New Credit Union premises
 2004 - 850 sq. m

Ryanair Engineering and Training Building, Dublin Airport

New Training and office building and hanger extension to tender stage.
 1999 - 3,500 sq. m

COMMERCIAL PROJECTS

Maldron Hotel, New Street, Dublin

New Hotel development of 137 bedroom hotel on city centre site.
 Ongoing - 5,700 sq. m

Holiday Inn Express, Sheffield

New Hotel part of Crowne Plaza / Express development of 360 bedroom hotel on city centre site.
 2010-2011 - 5,400 sq. m

Hotel and Retail Development, Letterkenny

58 Bedroom and 26 suite Hotel, public house, retail units and multi-storey carpark.
 1999 - 10,000 sq. m

Retail Development, Mullingar, Co. Westmeath

New Retail development with 5. no. units and public mall.
 2004 - 2005 - 18,950 sq. m

Phase 2 of development with 11no. retail units, leisure/gym facilities, medical centre and offices.
 Ongoing. 16,800 sq. m

Extension to Carlton Hotel Galway, Dublin Road, Galway

88 hotel suite extension to the existing hotel (complete). 2004. 9,250 sq. m

Development of public areas and an additional 80 bedrooms. 2007. 7,250 sq. m

Retail Park Development, Naas, Co. Kildare

Retail Park development with 10 no. units
 2005. 15,000 sq. m

Mixed-use Development, Carlow, Co. Carlow

New shopping centre with 36 retail units, basement carpark 30 residential units and offices.
 Ongoing. 49,500sq.m.

Retail Park Development, Portlaoise, Co. Laois

New Retail Park development with 10 units
 2008. 11,800sq.m.

Retail Park Development, Ennis, Co. Clare

New Retail Park development with 10no. retail units and 2no. light industrial units.
 2008. 9,400sq.m.

Lismard Business Park, Portlaoise, Co. Laois

Refurbishment of elevations and new canopies to existing car showrooms and retail warehouse units.
 2009.

Restaurant, Lismard Business Park, Portlaoise, Co. Laois

New restaurant with drive thru lane and parking
 2009 Planning. 280sq.m.

Mixed Development, Edenderry, Co. Offaly

Commercial development with mix of office, retail and light industrial units.
 2008 - 16,200sq.m.

RESIDENTIAL PROJECTS

Mount Wolsley Hotel and Golf Resort, Tullow, Co. Carlow

Residential development with 40no. apartments and 20no. executive houses.

FIT-OUT PROJECTS

Ryanair New Headquarters, Swords

Extension and fit-out of existing office building.
 2013 9,000 sq. m

PayPal, Dundalk

Refurbishment, conversion and fitting out of existing industrial building to provide new office space, restaurants, café, gym, training rooms and meeting rooms.
 2012 12,500 sq.m

Google European Headquarters, Dublin

Extension and fit-out of existing office building to provide office space for 1200 staff, a new 25m swimming pool, gym, 2 restaurants.
 2012 20,000 sq. m

The Pensions Board, Verschoyle House, 28-30 Lower Mount Street, Dublin 2

Fit-out of basement, first, second and penthouse floors.
 2001. 1,000 sq. m

Leinster Mills, Naas, Co. Kildare

Refurbishment and fit-out of one building for office use.
 1999. 390 sq. m

EDUCATION

Scoil Mhuire National School, Lucan, Co. Dublin

16 Classroom extension to existing school and refurbishment of existing buildings, external play areas and landscaping.
 2013 2,200 sq. m.

Warrenmount House, Blackpitts, Dublin 8

Refurbishment of Warrenmount House (protected structure) and Convent, change of use to adult education centre and offices.
 2011 1,600 sq. m.

CUSTODIAL

Limerick Prison

Design of new women's prison including rooms, recreation, education, visits and all associated facilities; extension to existing male prison including 101 cells, recreation and staff facilities; new Probation Service office building.
 2017 - 15,150 sq. m.

New Cork Prison

Design and construction of new prison including cells, recreation, education, visits and all associated facilities.
 2014-2015 - 19,000 sq. m.

Midlands Prison Extension, Portlaoise, Co. Laois

PPP design and tender submission for cell block, kitchens, workshops extension to existing prison.
 2010 - 14,600sq.m.

CULTURAL PROJECTS

Proposed Kildare County Museum, Leinster Mills, Naas, Co. Kildare

Refurbishment of Leinster Mills (protected structure) for mixed use and new museum, conference centre, design centre and office building.
 Scheme design 2000 - 10,000 sq. m



Project Kells



Amgen Pharmaceuticals



Bank of Ireland, Baginbun Plaza

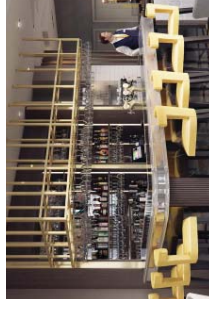

Maldron Hotel, Kevin Street



Holiday Inn Sheffield



Mount Wolsley Hotel Residential



Paypal, Dundalk

DEREK BYRNE

DIRECTOR

ROLE: DESIGN DIRECTOR



PROFESSIONAL PROFILE

Derek is a Director of Henry J. Lyons Architects with extensive experience across many sectors. He has a particular interest and is highly experienced in the design of Civic / Public Buildings and Educational projects.

H J Lyons Architects established a branch office in Abu Dhabi in 2010 and this was managed by Derek for 4 years where he completed projects in the Educational and Medical sectors. Since returning to Dublin Derek has formalized many years of project management by completing the Dip Proj Man Diploma course in TCD.

Derek has consistently led teams through delivery of a series of multi award winning buildings over the past 15 years. Some of these projects were won in architectural competition. Derek has acted as Project Manager and Design Director in respect of the following projects:-

Qualifications:
Dip, Arch Tech, MBIAT (Tech), MIDI

Education:
Diploma in Architectural Technology
DIT 1982

Bachelor of Architectural Technology
NOAI Level 7

Dip Project Management
TCD 2009

Registration:
MRIAI (Tech)
Member Royal Institute of Architects of Ireland (Tech)

MCIAT
Member of the Chartered Institute of Architectural Technologists

MIDI
Member of the Institute of Designers in Ireland (IDI)

MASTERPLANNING PROJECTS

Former Adli Site, Sandyford
The project comprises the masterplanning of a 1.56 Ha site as a high density residential quarter providing 460 Units in a variety of types and sizes, with individual building blocks rising up to 14 storeys in height.

Marina Park, Cork South Docks
Masterplan and full planning application for 10 hectare brownfield site overlooking the River Lee consisting of circa 250,000m² of mixed use development.

Blessington Town Centre, Co. Wicklow

New Town Centre Development adjoining the established Blessington village, comprising of: New Town Square, 80 Bedroom Hotel and, Leisure Centre, Supermarket & Retail units, Home and Business Units, 900 Apartments, Car parking for 1,000 cars, Civic Building, Theatre,

Industrial/Craft Starter Units, Crèche, Nursing Home, 25 Town Houses

PUBLIC PROJECTS

Clare County Council, Co Clare
The four story building includes 8,600 sqm of offices for approx. 300 staff, meeting rooms, staff canteen, laboratory, Council Chamber and 320 car parking spaces.

Mixed Use Leisure Development, Skerries
New Aquatic Centre and Community Facility, park & ride and 450 apartments at Skerries train station, north county Dublin. Winning Proposal in Dialogue Process Competition sponsored by Fingal County Council.

OFFICE/COMMERCIAL PROJECTS

HOB Refurbishment Dublin Airport, DAA
Energy Efficient Regeneration Project for the 8000 sq m Former HQ of Aer Lingus currently nearing completion and achieving A3 BER and Lead Platinum accreditation.

Six Bay Airport Terminal Extension, Dublin Airport
Extension and Refurbishment of existing terminal with new check-in and reclaim halls.

Treasury Building, Grand Canal Street, Dublin
Conversion and extension of historic Bolands Bakery building to 11,200m² office space with multi storey car park.

Carryfort Court, Blackrock, Dublin
3,500 sq.ft. office development at Blackrock by-pass.

Central Bank Relocation Project, Dublin
A new 60,000sq.ft. relocation for the Central Bank and Financial Services Authority of Ireland. A public sector project with a QCCC contract.

SCOR Global Life Reinsurance PLC, Dublin
Irish Headquarters of international company to accommodate 95 personnel on a floorplate of 1800 sqm.

EDUCATION PROJECTS

Scoil Chríost Rí Presentation Secondary, Portlaoise
850 student girls secondary school comprising 7400 sq.m in a 2 storey format organised as three academic clusters connected by a circulation spine. Scoil Chríost Rí shares a campus with another school with separate Sports Hall and facilities.

Gallen Community School, Ferbane
450 student post primary Community College, comprising 6200 sq.m and set along the river Brosna. Gallen OS includes an integrated PE hall, General Purpose Area and Drama Studio to maximise flexibility for College and Community use.

St. Kevin's Community School, Dunlavin, Co. Wicklow
3,107 sq.m extension to existing college including sports hall, general purpose area, specialist rooms, classrooms and ancillary areas all set around a new landscaped courtyard.

St. Mary's, Blessington, Co. Wicklow
16 classroom school, with integrated Community Theatre Facility. As team leaders Henry J. Lyons worked closely with the DOES, local resident groups and the BOM to successfully realize the innovative combined educational and community architectural brief.

Rabdan Academy, Abu Dhabi, UAE
Project comprising the regeneration and extension of an existing facility to provide a 3 storey 7490 sqm Military Academy for Crisis Management.

Dublin Business School, Aungier Street, Dublin
Regeneration and Extension of 4 storey Annex to DIT to provide 6200 sq.m of academic and social facilities for private Accountancy and Business College.

Public Private Partnership Community Colleges, Ferbane, County Offaly and Portlaoise, County Laois
Competition winning development of 2 new schools in the Midlands of Ireland, creating new Educational Campuses in each Town. Each School will provide a range of facilities including Sports Halls and Outdoor Sports Facilities.

Wicklow County Council Public Library at Blessington
New 350sqm public library located at civic square in Blessington New Town Centre

Public Private Partnership Community Colleges, Ferbane, County Offaly and Portlaoise, County Laois
Competition winning development of 2 new

schools in the Midlands of Ireland, creating new Educational Campuses in each Town. Each School will provide a range of facilities including Sports Halls and Outdoor Sports Facilities.

Environmental Protection Agency Headquarters, Co. Wexford

Competition winning Headquarters facility completed in 2000 and incorporating best practice, sustainable strategies, maximising natural light and ventilation.

Accountancy and Business College, Aungier St. Dublin 2
Extension and refurbishment of third level private College

National Headquarters for the Blind, Drumcondra, Dublin
Refurbishment of large period house as new NCBI Headquarters

TRANSPORT/INDUSTRY PROJECTS

Team Aer Lingus, Dublin Airport, Dublin
21,000sq.m Aircraft Maintenance Facility with offices

Six Bay Airport Terminal Extension, Dublin Airport
Extension and Refurbishment of existing terminal with new check-in and reclaim halls.

Ryanair HQ, Dublin Airport
Irish Pensions Board HQ (Fit-Out), Dublin

Dublin Airport Duty Free
1600m² Tax and Duty Free Shopping Mall Fit out.

Dublin Airport Authority, Dublin
Commercial masterplan for 1,100,000 sq.m. Development comprises of hotels, office parks, industrial units, transport termini, multi-storey car parks and surface carparks and new mono rail system.

Pier C, Dublin Airport, Dublin
Extension to existing Terminal building and new 6-airbridge pier building. Size 25,000m² Value €53.3m

Aer Rianta, Shannon Airport, Co.Clare
Flagship Office Building (3,000 sq. m).

HEALTHCARE PROJECTS

St. James's Hospital Mortuary, Dublin
The new ensemble of Mortuary building 3,673sq.m and car park is separated from the light rail stop by a new landscaped park, 33m long x 13.5m wide

St. James's Hospital Luas Project, Dublin
The passage of the Luas through the hospital campus necessitated the demolition and replacement of facilities including the Mortuary and Post Mortem Facilities, industrial Laundry and services infrastructure such as ESB substations.

LEISURE AND TOURISM PROJECTS

Kinsale Golf Resort, Co Cork
500 acre spectacular headland site to include 18 hole championship Golf course, Club House and Golf Academy, 180 Room 5 Star Hyatt Resort Hotel with Conference Centre and spa, Equestrian Centre and 230 Vacation lodges.

Hangman's Point Hyatt Golf Resort, Kinsale County Cork (To Statutory Approval Stage)
210 hectare (520 acre) Golf Resort on spectacular elevated headland in Ireland's Gourmet Capital.
Quinta Bela Mandil Golf and Spa Resort, Olhoa, Algarve, Portugal
210 hectare

(579 acres) Golf Resort with Ernie Els designed course, 5-Star Conference Hotel, 4-Star Family Hotel, Aparthotel, Village, Business and Retail Centre International Destination Spa and 1513 Residential Units.

Mount Congreve Estate Garden Resort, Co. Waterford

202 hectare (500 acre) Integrated Country Club Resort with the spectacular Mount Congreve Gardens on the River Suir as the centre piece, including a 5-Star riverside Hotel, Marina Conference and Leisure Hotel, Garden, Retail Centre, Public Facilities including Garden Interpretive Centre, Museum and Restaurant, 220 Apartment Village, 100 Villas and 4 ha (9.8 acre) expansion of the Village of Bawnfune.

Hangman's Point Hyatt Golf Resort, Kinsale County Cork
210 hectare (520 acre) Golf Resort on spectacular elevated headland in Ireland's Gourmet Capital, Kinsale, including Ernie Els designed 18-hole championship Golf course, Club House and Golf Academy, 5 Star Hyatt Conference Centre and Spa, Equestrian Event Centre and 230 Vacation Lodges.

Trinakilly House Leisure and Tourism Resort, County Wicklow
40 hectare (99 acres) redevelopment of the famous Blue Book waterside Trinakilly House Hotel protected structure to include new Bedroom Wing, Conference and Wedding Centre, Restaurant and Bar, 30 home Retirement Village, 100 Holiday Homes, Children's Outdoor Pursuits and Sports Facility, Ontology Centre and Keeps and extensive waterside and country walks.

Kimcore Quay Integrated Golf Resort, County Wexford
242 hectare (600 acre) ocean side Golf Resort including Ernie Els designed 18-hole championship Golf Course, Club House, 5 Star Fairmont Hotel, Conference Centre and Spa, Equestrian Centre, Marina and 280 Vacation Villas.

Blessington Town Centre Hotel, Co. Wicklow,
90 Bedroom Urban Event Hotel with Conference Rooms, Business Centre and Leisure Centre located on a public square in the Blessington New Town Centre.

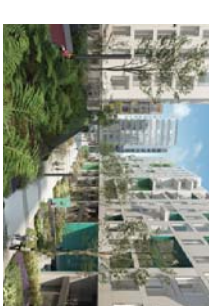

Twyway Residential



Cork South Docks



Rosegarden Marana, Bahrain



Dublin Airport Central



One DAC



Kinsale Golf Resort



Clare County Council

SINEAD MCMAHON

ARCHITECT

ROLE: ARCHITECT



PROFESSIONAL PROFILE

Sinead graduated from the School of Architecture, UL in 2011, receiving an AAI Commendation for her final year thesis. Since then Sinead has gained a broad range of experience in both Ireland and New York. Previous experience in Ireland includes urban design, commercial fit outs, architectural teaching and research. In New York Sinead gained experience* working with an established design firm as project architect on large scale hospitality and high-end residential projects, as well as a range of interior fit outs.

Qualifications:

B.Arch Hons

Education:

Professional Diploma in Architectural Practice RIAI Part III (DIT)

B.Arch Hons
(UL) 2011

Registration:

MRIAI Member of the Royal Institute of Architects in Ireland

HOSPITALITY PROJECTS

Druids Glen Hotel & Resort, Co. Wicklow
The extension of the existing hotel lounge and bar through design of an additional bar pavilion overlooking the golf course. The brief also includes the upgrading of existing pavilion exterior and high end interior design of new and existing lounge. Bar extension completed in 2018, with spa renovations planned for late 2018/2019.

Maldron Hotel, Kevin St, Dublin 2
Design, construction and completion of a new 140 bedroom Maldron Hotel to include public area, staff facilities and basement car park. Project is due for completion in June 2018.

Hyatt Times Square, New York*
This 54 storey high-end hospitality development is Hyatt's largest New York hotel, located in Times Square. The brief included 480 guestrooms as well as a public lobby, meeting room suite, spa, gym and roof-top bar. Completed 2013.

Leinster Mills, Naas, Co. Kildare
Scheme Design for alteration and refurbishment of existing mill building as restaurant and office suite, to be linked to new build office development.

RETAIL PROJECTS

Dawson St - Nassau St Retail & Office Development, Dublin 2
The design of 7,500m² of high-end retail trading over three floors on a prime city centre as part of a mixed-use development. The scheme must provide high quality, flexible and well-serviced space to meet international retail market demands.

Liffey Valley Phase II, Dublin
The development of Liffey Valley Town Centre and Plaza is intended to be the prime node of the Liffey Valley Retail experience. Phase II will deliver an additional 24,350m² of retail, as well as a substantial leisure and Food & Beverage service. The development also consists of 2000 capacity multi-storey car park and an Ice Hockey Arena. Phase II of the centre has an overall development of 108,000m².

Carlow Town Retail Centre, Carlow
Large shopping centre development in Carlow Town also incorporating an underground car park, small residential scheme and adjacent parkland.

RESIDENTIAL PROJECTS

Cork Street Student Housing
Feasibility and scheme design for the development of 200 bed student accommodation scheme with ground floor retail, management suite and student facilities.

30th St + Park Avenue, NY*

Bespoke design of a 2,300 sq ft apartment in Manhattan for a small family. This project featured a highly detailed and complex fit out, catering for specific client needs and high quality finishes.

COMMERCIAL PROJECTS

Dawson St - Nassau St Retail & Office Development, Dublin 2

High end architectural design of a mixed use building incorporating 10,000m² office space over four floors, with supporting car park, plant and servicing facilities.

Leinster Mills, Naas, Co. Kildare

Alteration and refurbishment of existing mill building as office development, also incorporating ground floor hospitality and museum.

9 College Green, Dublin 2

Ciaizing design, replacement and fire upgrade works to prime building on College Green currently under commercial use.

Eastpoint Business Park, Block N Fit Out

Feasibility and scheme design for relocation of large commercial body to new premises. The project involved a new fit out and complex planning of various departments all with very particular requirements and security standards.

CUSTODIAL PROJECTS

Cork Prison Redevelopment

Design and construction of new prison including cells, recreation, education, visits and all associated facilities. Completed 2015 - 19,000 sq. m.

SPORT/ LEISURE PROJECTS

Trinity Sports Centre, TOD, Dublin 2

Internal alterations and extension of existing gym facilities and staff areas within university sports centre. Completed 2017.

National Indoor Arena

Scheme design for the newest addition to the National Sports Campus facilities. The development will include a National Indoor Athletics Track, a National Indoor Sports Centre and a National Gymnastics Training Centre.

MASTERPLANNING PROJECTS

Crowne Site, Galway

A site masterplan for a prominent Galway development including a small business park, residential buildings, hotel and leisure facilities, public plaza and pedestrian connectors.



Druids Glen Hotel & Resort



Hyatt Times Square, New York



Dawson Street



Liffey Valley Phase II



Maldron Hotel, Kevin Street

ROLDAN JACOBY
ASSOCIATE
ROLE: DEISGN ARCHITECT



PROFESSIONAL PROFILE

Over 18 years of professional experience, Roldan developed significant expertise in the design and delivery of diverse architectural projects.

His experience includes residential, educational, commercial and public building projects from inception to completion.

Roldan joined H.J.L since 2004 and was appointed as associate in 2008. Between 2011 and 2015, returned to Buenos Aires to develop independent projects, and now continues collaborating with H.J.L.

Qualifications:
Architect Arq. CPAU

Education:
Architect
FADU UBA (AR) 2000
Certified Passivhaus Designer
Passivhaus Institute, 2010

Registration:
CPAU
Member of Architecture and Urbanism Council of Argentina

RIAI
Applicant to RIAI Membership (In progress)

ACBC
Member of Argentina Green Building Council

MASTERPLANNING / URBAN DESIGN

Tiway Residential Project, Sandyford (2016-2018)
Masterplanning of a 1.5 Ha site as a high density residential quarter in Sandyford, Co. Dublin.

Dublin Airport Central (2016)
Masterplanning for the second phase of the LEED Gold office development at Dublin Airport comprising of 6 office blocks totalling ca 50,000 sqm and urban park.

Rosegarden Manama, Bahrain (2010)
The masterplan offers a range of luxury accommodation ranging from beachfront private villas to a seven star hotel, retail, marina apartment accommodation, and the fifty storey Rose Tower offering hotel, leisure and luxury apartments on a peninsula location.

Sherries Mixed Use Leisure Development (2008)
New Aquatic Centre and Community Facility, park & ride and 450 apartments at Sherries train station, north county Dublin. Winning Proposal in Dialogue Process Competition sponsored by Fingal County Council.

Marina Commercial Park, Cork (2010)
Conceptual development of Mixed use proposal located in the Cork Dockslands, 200,000 sqm

Waterfront Development, Arklow (2008)
Mixed use development proposal for a spectacular 13 acre site on the Arklow South Docks, 130,000 sqm

Blessington Town Centre, Blessington, Co. Wicklow (2004 – 2011)
New Town Centre Development adjoining the established Blessington village.

RESIDENTIAL PROJECTS

Tiway Residential Project, Sandyford (2018)
460 apartments, 500 carparking spaces, and associated ancillary uses in a variety of types and sizes distributed in 6 individual building blocks rising from 6 to 14 storeys in height. Planning application lodged in April 2018.

Tuath Housing (2017)
Ongoing feasibility study for 150 apartments on a 1Ha. Site in Blanchardstown, Co. Dublin

Cornellscourt (2017)
Feasibility study for 250 apartments on a 1.5 Ha site in Cornellscourt, Co. Dublin.

Residential buildings in Buenos Aires (2012-2015)
Developed, designed and built a block of 12 apartments and 2 family homes as an independent architect.

Residential development in Talca, Chile (2012)
Conceptual design development for 3 prototype houses on a challenging site on the Andes mountains.

Blessington Avenue Apartments (2011)
23 apartments over a ground floor retail unit as part of the town centre development.
COMMERCIAL & OFFICE PROJECTS
One DAC, Dublin Airport (2015)
Now home to ESB, the refurbishment of the 10,000 sqm former Aer Lingus building was the first certified LEED Platinum building in Ireland. Highly commended at RIAI Awards 2016.

Dublin Airport Central (2016)
Design development of Cluster A phase 1, comprising blocks A1 and A6 of the DAC project at Dublin Airport, following the successful delivery of One DAC in 2015.

Áras Contae an Chláir, Ennis, IE
The award winning four story building includes 8,600 sqm of offices for approx. 300 staff, with an impressive public atrium and the County Council Chamber.

Aquavetro, Dublin Dockslands (2011)
Private Competition proposal for the redevelopment of warehouses as Office Buildings at Grand Canal Docks, 15,000 sqm.

Rosewater Tower, Bahrain (2009)
50 storey Mixed Use Development comprising of a 7* Luxury Hotel, Residential and Office towers. Shopping Centre and amenities, 100,000 sqm

The Crescent, Athlone (2010)
Planning Application for a commercial office building, 5,000 sqm

Houses of Parliament, Buenos Aires (2002)
Award winning entry to design and construct a 4,000 sqm office extension for the Houses of Parliament in Buenos Aires.

LEISURE AND TOURISM PROJECTS

Kinsale Golf Resort
500 acre spectacular headland site to include 18 hole championship Golf course, Club House and Golf Academy, 180 Room 5 Star Hyatt Resort Hotel with Conference Centre and spa, Equestrian Centre and 250 Vacation lodges.

AWARDS

RIAI Irish Architecture Awards 2016
One DAC, Dublin Airport
Sustainable building (Commended)

LAMA Best Public Building Award 2009
Áras Contae an Chláir

RIAI Irish Architecture Awards 2008
Áras Contae an Chláir

Irish Institute of Design Awards 2008
Áras Contae an Chláir

Bank of Ireland OPUS Awards 2008
Áras Contae an Chláir

COMPETITIONS
Annex "C", House of Parliament of Argentina
1st prize, 2004

PUBLICATIONS

Clare County Hall
Architecture Ireland, Jul 2008
Construct Ireland, Mar 2008
Summa+95

Casa El Gazal, Aug 2013
Arqa.com
CASAS Internacional

Scoil Croisí Rí Portlaoise, Sep 2010
Leinster Express

Edificio de Viviendas, Jul 2008
Summa+94



Tiway Residential



Cork South Docks



Rosegarden Manama, Bahrain



Dublin Airport Central



One DAC



Kinsale Golf Resort



Clare County Council

Name:	Keith Mitchell
Position:	Associate Director
Qualifications	1996 M.A Hons (Landscape Architecture)
	1998 Member of the Irish Landscape Institute
	2000 Chartered Membership of The Landscape Institute (UK)
	2001 Diploma – Environmental Impact Assessment Management
	2012 Diploma – Arboriculture (Level 4)
	2013 Technician Member of The Arboricultural Association
	2014 Tree Risk Assessment Qualification (International Society of Arboriculture)
Health & Safety	2013 “Safe Pass” Health & Safety Awareness Training
	2014 ‘Safety By Design’ – Role of designer under construction regulations course RIAI CPD

Experience

2006 to date	Associate Director, Cunnane Stratton Reynolds (Galway)
2002 – 2006	Principal Landscape Architect, Cunnane Stratton Reynolds (Cork)
2001 – 2002	Expedition Leader, Coral Cay Conservation (Phillipines)
1999 - 2001	Senior Landscape Architect, Brady Shipman Martin (Dublin).
1998 – 1999	Project Landscape Architect, Cunnane Stratton Reynolds (Dublin)
1997 – 1998	Landscape Architect, Environmental Design Partnership (Johannesburg)
1996 – 1997	Graduate Landscape Architect, James Cuning Young (Edinburgh)
1994 – 1995	Internship Landscape Architect, Aspinwall Clouston (Hong Kong)

Keith Mitchell is a Chartered Landscape Architect who trained in Scotland & the USA. He has over 20 years professional experience in Landscape & Urban Design and is responsible for management of CSR's Galway Office. Building on a broad foundation of international experience, Keith has subsequently lead and assisted design teams on a wide range of private and public development projects throughout Ireland and the UK.

His extensive experience in the field of *Environmental Impact Assessment* has focused on '*Landscape and Visual Impact Assessment*', which he has carried out for a wide variety of development types. He has also successfully completed training with The Heritage Council in '*Landscape Character Assessment*'.

In addition, Keith is also a qualified Arborist who regularly undertakes tree surveys for private and public-sector clients.